

MS SERIES THREE-PHASE ASYNCHRONOUS MOTORS WITH ALUMINIUM HOUSING

- Conform to the IEC standard
- Be made of selected quality material, latest design in entirety
- Good performance, low noise, little vibration, and safety and reliable cooperation
- Nice appearance, light weight
- Be maintained very conveniently, simple construction
- Be used for general drive
- The Efficiency meet EFF2 standards.

- 符合IEC标准
- 优质材料，设计新颖
- 高性能，低噪音，低振动，操作安全可靠
- 外形美观，重量轻
- 维护方便，结构简单
- 用于一般驱动
- 效率符合EFF2标准



IMB3

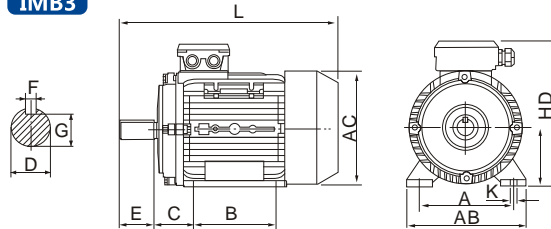

IMB14

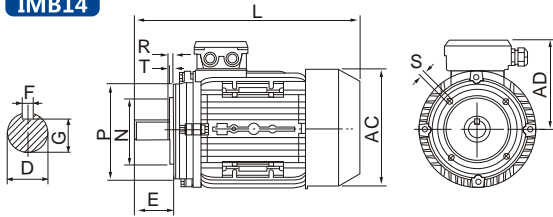

IMB5

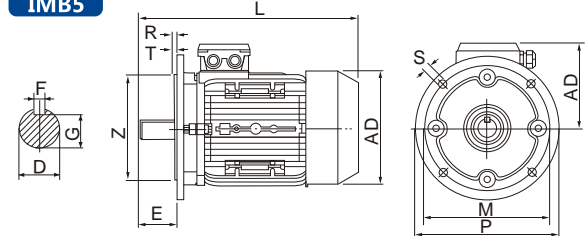

外形及安装尺寸 OVERALL & INSTALLATION DIMENSIONS

机座号 Frame size	装配尺寸 Mounting Dimensions(mm)																				外型尺寸 Overall					
	安装尺寸 Installation Size (mm)								IMB14					IMB5					Dimensions (mm)							
	A	B	C	D	E	F	G	H	M	N	P	R	S	T	M	N	P	R	S	T	AB	AC	AD	HD	L	
MS56	90	71	36	9	20	3	7.2	56	5.8	65	50	80	0	M5	2.5	98	80	120	0	7	3	110	120	110	155	195
MS63	100	80	40	11	23	4	8.5	63	7	75	60	90	0	M5	2.5	115	95	140	0	10	3	130	130	115	165	230
MS71	112	90	45	14	30	5	11	71	7	85	70	105	0	M6	2.5	130	110	160	0	10	3.5	145	145	125	185	255
MS80	125	100	50	19	40	6	15.5	80	10	100	80	120	0	M6	3	165	130	200	0	12	3.5	160	165	135	215	295
MS90S	140	100	56	24	50	8	20	90	10	115	95	140	0	M8	3	165	130	200	0	12	3.5	180	185	145	235	335
MS90L	140	125	56	24	50	8	20	90	10	115	95	140	0	M8	3	165	130	200	0	12	3.5	180	215	145	235	360
MS100L	160	140	63	28	60	8	24	100	12	130	110	160	0	M8	3.5	215	180	250	0	15	4	205	240	170	255	380
MS112M	190	140	70	28	60	8	24	112	12	130	110	160	0	M10	3.5	215	180	250	0	15	4	245	240	180	285	400
MS132S	216	140	89	38	80	10	33	132	12	165	130	200	0	M10	4	265	230	300	0	15	4	280	275	195	325	475
MS132M	216	178	89	38	80	10	33	132	12	165	130	200	0	M10	4	265	230	300	0	15	4	280	275	195	325	515
MS160M	254	210	108	43	110	12	37	160	15	215	180	250	0	M12	4	300	250	350	0	15	5	320	330	255	420	615
MS160L	254	254	108	42	110	12	37	160	15	215	180	250	0	M12	4	300	250	350	0	15	5	320	330	255	420	670

技术数据 TECHNICAL DATA AT 50 HZ

型号 Model	功率Power		电压 Voltage (V)	电流 Current (A)	转速 Speed (r.p.m)	效率 Eff (%)	功率因数 Power factor	堵转转矩 额定转矩 Tst/Tn(Times)	最大转矩 额定转矩 Tmax/Tn(Times)	堵转电流 额定电流 Ist/In(Times)	净重 N.W.(kg)
	KW	HP									
MS561-2	0.09	0.12	220/380	0.57/0.33	2800	62	0.68	2.3	2.4	6	4.6
MS562-2	0.12	1/6	220/380	0.67/0.38	2800	67	0.71	2.3	2.4	6	4.8
MS631-2	0.18	1/4	220/380	0.91/0.53	2800	69	0.75	2.2	2.4	6	5
MS632-2	0.25	1/3	220/380	1.17/1.68	2800	72	0.78	2.2	2.4	6	5.3
MS711-2	0.37	1/2	220/380	1.65/0.95	2800	73.5	0.8	2.2	2.4	6	6.5
MS712-2	0.55	3/4	220/380	2.33/1.35	2800	75.5	0.82	2.2	2.4	6	7
MS801-2	0.75	1	220/380	3.03/1.75	2800	76.5	0.85	2.2	2.4	6	8.8
MS802-2	1.1	1.5	220/380	4.42/2.55	2800	77	0.85	2.2	2.4	6	11
MS90S-2	1.5	2	220/380	6.01/3.48	2800	77	0.85	2.2	2.4	6	12.3
MS90L-2	2.2	3	220/380	8.61/4.98	2800	78	0.86	2.2	2.4	6	15
MS100L-2	3	4	220/380	11.1/6.4	2870	82	0.87	2.2	2.3	6	20.5
MS112M-2	4	5.5	380/660	8.2/4.7	2890	85.5	0.87	2.2	2.3	7	24
MS132S1-2	5.5	7.5	380/660	11/6.3	2900	85.5	0.88	2	2.2	7	30
MS132S2-2	7.5	10	380/660	15/8.6	2900	86.2	0.88	2	2.2	7	39.5
MS160M1-2	11	15	380/660	21.3/12.2	2930	88	0.88	2	2.2	7	82
MS160M2-2	15	20	380/660	28.7/16.4	2930	89	0.89	2	2.2	7	91
MS160L-2	18.5	25	380/660	34.6/19.8	2930	90	0.9	2	2.2	7	106
MS561-4	0.06	0.08	220/380	0.49/0.28	1400	56	0.58	2.1	2.4	6	4.6
MS562-4	0.09	0.12	220/380	0.67/0.39	1400	58	0.61	2.1	2.4	6	4.8
MS631-4	0.12	1/6	220/380	0.84/0.48	1400	60	0.63	2.2	2.4	6	4.8
MS632-4	0.18	1/4	220/380	1.12/0.66	1400	64	0.66	2.2	2.4	6	5
MS711-4	0.25	1/3	220/380	1.44/0.83	1400	67	0.68	2.2	2.4	6	6.3
MS712-4	0.37	1/2	220/380	1.94/1.12	1400	69.5	0.72	2.2	2.4	6	6
MS801-4	0.55	3/4	220/380	2.69/1.56	1400	73.5	0.73	2.2	2.4	6	9
MS802-4	0.75	1	220/380	3.48/2.01	1400	75.5	0.75	2.2	2.4	6	9.5
MS90S-4	1.1	1.5	220/380	4.74/2.75	1400	78	0.78	2.2	2.4	6	13
MS90L-4	1.5	2	220/380	6.31/3.65	1400	79	0.79	2.2	2.4	6	15
MS100L1-4	2.2	3	220/380	8.6/5.0	1430	81	0.82	2.2	2.3	5.5	20.3
MS100L2-4	3	4	220/380	11.7/6.8	1430	82.5	0.81	2.2	2.2	5.5	23.5
MS112M-4	4	5.5	380/660	8.8/5.1	1440	84.5	0.82	2.2	2.3	7	29.5
MS132S-4	5.5	7.5	380/660	12/6.9	1440	85.5	0.84	2.2	2.2	7	39.5
MS132M-4	7.5	10	380/660	15/8.6	1440	87	0.85	2.2	2.2	7	47.5
MS160M-4	11	15	380/660	22.3/12.7	1460	88	0.85	2	2.2	7	95
MS160L-4	15	20	380/660	30/17.1	1460	89	0.85	2	2.2	7	110
MS90S-6	0.75	1	220/380	4.0/2.3	910	72.5	0.7	2	2.2	6	14.5
MS90L-6	1.1	1.5	220/380	5.5/3.2	910	73.5	0.72	2	2.2	6	17
MS100L-6	1.5	2	220/380	6.9/4.0	940	77.5	0.74	2	2.3	7	22.5
MS112M-6	2.2	3	220/380	9.7/5.6	940	80.5	0.74	2	2.2	6	29
MS132S-6	3	4	220/380	12.4/7.2	960	83	0.76	2	2	6.5	48
MS132M1-6	4	5.5	380/660	9.4/5.4	960	84	0.77	2	2	6.5	49
MS132M2-6	5.5	7.5	380/660	13/7.5	960	85.3	0.78	2	2	6.5	57.5
MS160M-6	7.5	10	380/660	16.5/9.43	970	86	0.8	2	2	6.5	93
MS160L-6	11	15	380/660	24.1/13.8	970	87.5	0.79	2	2	6.5	107
MS132S-8	2.2	3	220/380	10/5.8	710	85.5	0.71	2	2	5.5	39
MS132M-8	3	4	220/380	13.3/7.7	710	82	0.72	2	2	5.5	45
MS160M1-8	4	5.5	380/660	10.2/5.8	720	81	0.73	2	2	6	88
MS160M2-8	5.5	7.5	380/660	13.6/7.8	720	83	0.74	2	2	6	96
MS160L-8	7.5	10	380/660	17.7/10.1	720	85.5	0.75	2	2	6	112

Note: 230/400V/50Hz 240/415V/50Hz, 400/690V/50Hz, 420V/50Hz 380/440V/50/60Hzets. Models are available on request
 备注：可以按要求生产230/400V/50Hz 240/415V/50Hz, 400/690V/50Hz, 420V/50Hz 380/440V/50/60Hz 等电压频率